

Single Trap Installation - Standard Field Fabricated Installation



TVS 4000 Armstrong Compact Trap Valve Station

Figure 1

1000 traps = 5000 valves = 5000 possible stem and body gasket leaks

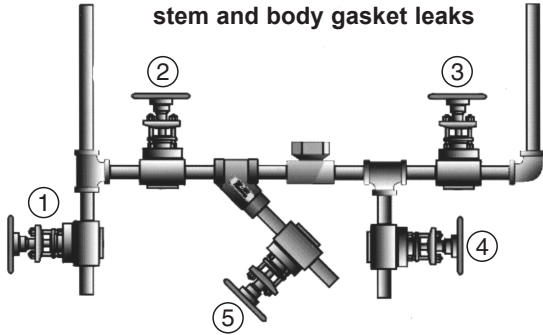

Overall length greater than 30 inches (762 cm)

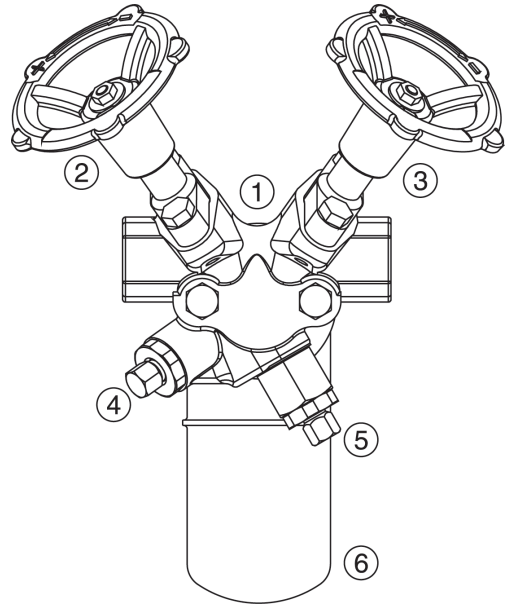

Overall face to face less than 5 inches (127 mm)

Valve Functions

- ① Trap inlet line start-up blowdown valve (visual)
- ② Trap inlet isolation valve
- ③ Trap outlet isolation valve
- ④ Return line blowdown and test valve (visual)
- ⑤ Strainer blowdown valve (visual)

Gate and globe valves have exposed rising stems which can corrode and gather dirt which tears stem packing and causes steam leaks.

TVS 4000 Assembly Components

- ① TVS 4000 cast stainless steel connector block
- ② Trap inlet isolation valve
- ③ Trap outlet isolation valve
- ④ Full port needle style test valve
- ⑤ Strainer with blowdown valve
- ⑥ Armstrong 2011 all stainless steel inverted bucket steam trap

Piston valve has enclosed non-rotating rising stem which protects the stem from corrosion and dirt.

3 year guarantee against defective materials or workmanship.

Standard Trap Instal. Figure 1 Qty.	Custom Standard Trap Instal. Qty.	Description	Unit Cost	Total Cost
5		1/2" 600# Rated Globe or Gate Valves		
8		1/2" Sch. 80 Nipples		
2		1/2" Line "Tee"		
1		1/2" Elbow		
1		1/2" Line Strainer		
1		1/2" Steam Trap		
16		1/2" Welds		
_____ hrs	_____ hrs.	Approximate Assembly Time		

Grand Total Cost _____

Qty. Unit Cost Total Cost
TVS 4000
