

| METER SIZE (IN) | ANSI RATING | "L" (IN) | "H" (IN) | WEIGHT (LBS) |
|-----------------|-------------|----------|----------|--------------|
| 1/2 | 150 | 7.87 | 8.03 | 17 |
| | 300 | 7.87 | 8.19 | 19 |
| 3/4 | 150 | 7.87 | 8.23 | 19 |
| | 300 | 7.87 | 8.62 | 23 |
| 1 | 150 | 7.87 | 8.43 | 20 |
| | 300 | 7.87 | 8.74 | 28 |
| 1-1/4 | 150 | 7.87 | 8.62 | 23 |
| | 300 | 7.87 | 8.94 | 29 |
| 1-1/2 | 150 | 7.87 | 9.02 | 24 |
| | 300 | 7.87 | 9.57 | 36 |
| 2 | 150 | 7.87 | 9.80 | 29 |
| | 300 | 7.87 | 10.08 | 36 |
| 2-1/2 | 150 | 7.87 | 10.59 | 33 |
| | 300 | 7.87 | 10.87 | 45 |
| 3 | 150 | 7.87 | 11.18 | 37 |
| | 300 | 7.87 | 11.57 | 51 |
| 4 | 150 | 9.57 | 12.28 | 42 |
| | 300 | 9.57 | 12.80 | 74 |
| 5 | 150 | 9.84 | 13.19 | 51 |
| | 300 | 9.84 | 13.70 | 82 |
| 6 | 150 | 11.81 | 14.29 | 62 |
| | 300 | 11.81 | 15.04 | 95 |
| 8 | 150 | 13.78 | 16.69 | 79 |
| | 300 | 13.78 | 17.48 | 177 |
| 10 | 150 | 17.72 | 19.65 | 112 |
| | 300 | 17.72 | 20.39 | 244 |
| 12 | 150 | 19.69 | 22.13 | 156 |
| | 300 | 19.69 | 22.87 | 337 |
| 14 | 150 | 21.65 | 24.17 | 180 |
| | 300 | 21.65 | 25.20 | 438 |
| 16 | 150 | 23.62 | 26.38 | 218 |
| | 300 | 23.62 | 27.40 | 543 |
| 18 | 150 | 23.62 | 28.19 | 251 |
| | 300 | 23.62 | 29.69 | 599 |
| 20 | 150 | 23.62 | 30.43 | 295 |
| | 300 | 23.62 | 31.93 | 715 |
| 24 | 150 | 23.62 | 34.84 | 361 |
| | 300 | 23.62 | 36.85 | 1074 |

NOTES:

- ① REMOTE FLOWMETER
- ② REMOTE DISPLAY ENCLOSURE
- ③ BACNET ADAPTER
- ④ 1/4"-20 UNC FLANGE TAPS FOR GROUNDING.
- 5. OFFERED IN 150# AND 300# FLANGES.
- 6. CARBON STEEL BODY AND FLANGES.

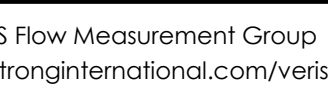
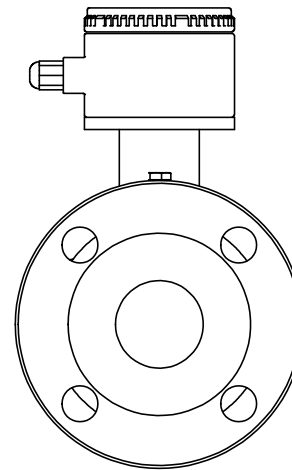
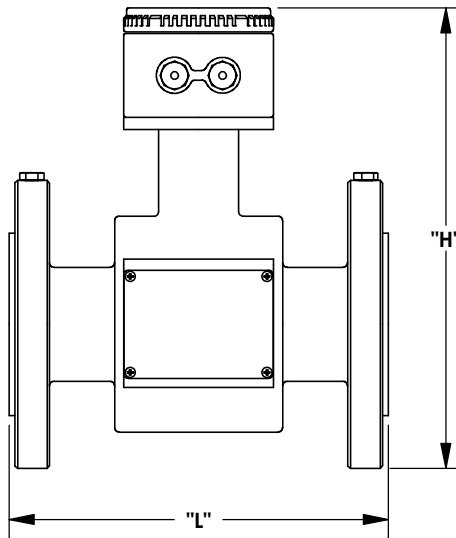
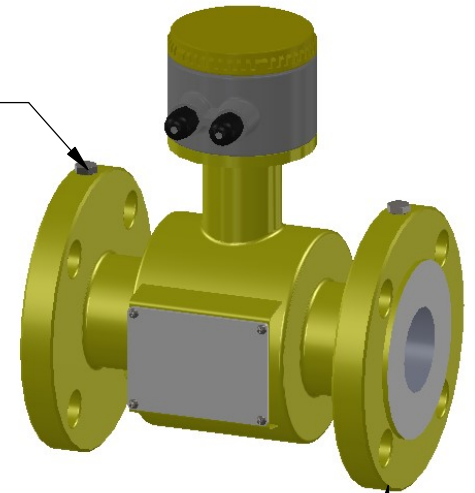
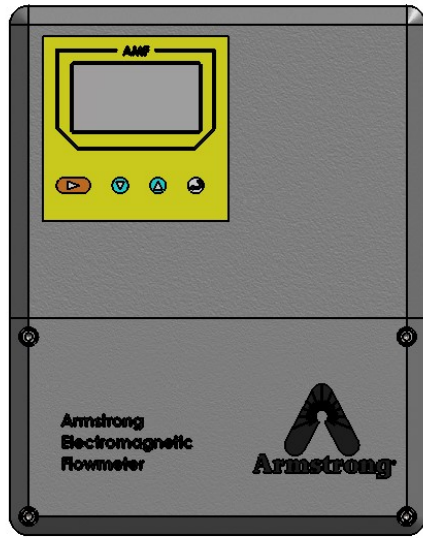

VERIS Flow Measurement Group
armstronginternational.com/veris

ARMSTRONG
ELECTROMAGNETIC FLOWMETER

5820 Glacier Way
Frederick, CO 80516 USA

Phone: (303) 652-8550
Fax: (303) 652-8552

DATE:
10/20/2019

DWG. NO.
AMF-REMOTE

SCALE: NTS

REV: A PAGE 1 OF 1