



SH Series Superheat Traps

Bimetallic Steam Traps For Superheat Conditions

For Pressures to 1800 psig (124 barg)...Cold Water Capacities to 6500 lb/hr (2950 kg/hr)

Steam Trapping and
Steam Tracing Equipment

Description

Armstrong's SH Series Bimetallic Steam Traps for superheat or low load conditions are the ideal traps for applications where other trap styles are not suitable for long life.

The Armstrong SH Series bimetallic traps also have the ability to handle the large start-up loads associated with superheat applications. The unique bimetallic element allows for shut-off before superheat reaches the trap, thus preventing steam loss. The SH-900 series utilizes titanium valves and seats to ensure extremely long service life in the harsh environment of superheated steam systems.

Maximum Operating Conditions

Maximum allowable pressure (vessel design):

Model SH-300:	580 psig @ 662°F (40 barg @ 350°C)
Model SH-900L and H:	900 psig @ 900°F (62 barg @ 482°C)

Maximum operating pressure:

Model SH-300:	319 psig (22 barg)
Model SH-900L:	650 psig (45 barg)
Model SH-900H:	900 psig (62 barg)

Suggested minimum operating pressure:

Model SH-300:	Not applicable
Model SH-900L and H:	200 psig (14 barg)

Connections

Model SH-300:	Screwed BSPT and NPT, socketweld, flanged DIN or ANSI (welded)
Model SH-900:	Socketweld, flanged, buttweld, screwed, NPT, BSPT

Materials

Model SH-300

Body and cap:	ASTM A105 ASTM A350-LF2
Valve and seat:	Chrome Steel - 440C
Elements:	Nickel plated
Strainer:	Stainless steel screen

Model SH-900

Body and cap:	ASTM A351 Gr. CF8M
Valve and seat:	Titanium
Elements:	Ni-Cr and stainless steel
Strainer:	Stainless steel screen

Specification

Bimetallic style steam traps in carbon steel (Model SH-300) or stainless steel (Model SH-900) with integral stainless steel strainer, in-line repairable. The mechanism shall consist of a stacked nickel-chrome bimetal operator (SH-300 nickel plated) with titanium valve and seat (SH-300 chrome steel valve and seat). The steam trap shall be capable of operation on low-load applications throughout its pressure/temperature range.

How to Order

- Specify model number
- Specify maximum operating pressure
- Specify size and type of pipe connection. When flanges are required, specify type of flange in detail



SH Series Superheat Traps

Bimetallic Steam Traps For Superheat Conditions

For Pressures to 1800 psig (124 barg)...Cold Water Capacities to 6500 lb/hr (2950 kg/hr)

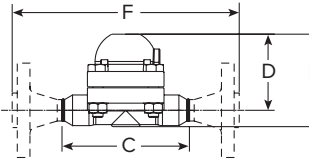
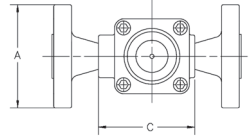
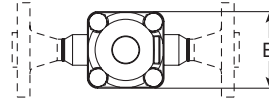
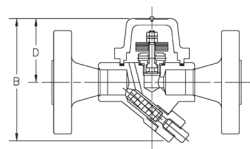

Model SH-300

Model SH-900

SH Series Dimensions and Weights				
Model	SH-300		SH-900	
	in	mm	in	mm
Pipe Connections	1/2, 3/4, 1***	15, 20, 25	1/2, 3/4, 1**	15, 20, 25
"B" Height	4-1/2	115	4-1/2	115
"C" Face-to-Face	3-1/2	90	6-1/4	158
"D" \varnothing to Top	2-5/16	59	3-3/4	95
"E" Width	—	—	3-3/4	95
**"F"	—	—	11	279
Weight, lb (kg)	4.1 (1.9)		10 (4.4)	

**"F" dimensions for SH-900 are for 3/4" connection, class 600 flanged. Consult factory for dimensions of models with other connection sizes and/or flanges.

** SH-900 1" butt weld.

***SH-300 1" only available as flanged connections.

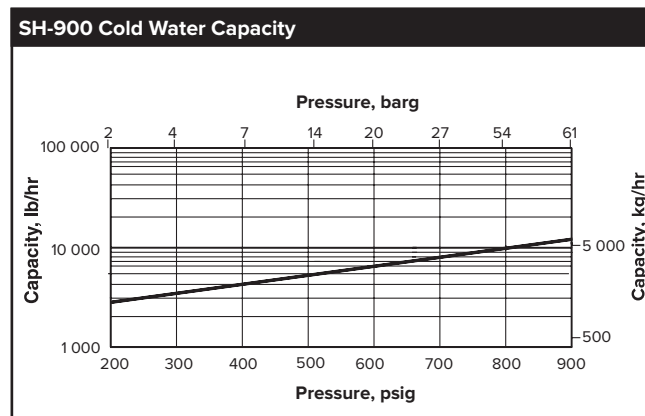
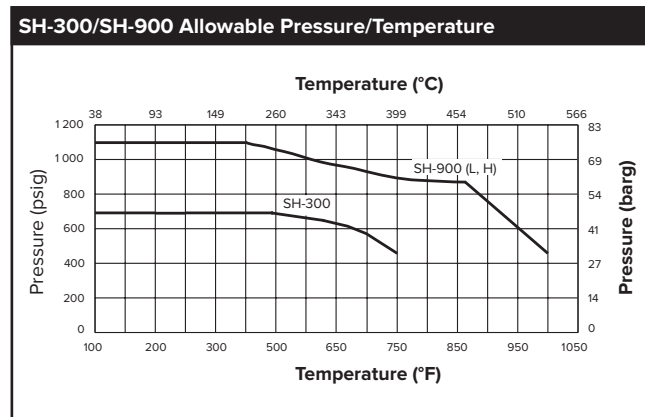

Designs, materials, weights and performance ratings are approximate and subject to change without notice. Visit armstronginternational.com for up-to-date information.