



# Double Duty® 4 Steam Trap/Pump Combination

### Description

Armstrong's Double Duty® Series steam trap/pump combination offers a low profile solution to draining heat exchangers in various applications.

The Double Duty® 4 is a low profile pump that offers you the versatility of combining a pump within a steam trap to aide in condensate drainage from a heat exchanger under all operating conditions.

### Features

- Economical. non-electric operation
- Low-maintenance operation. No leaking seals, impeller or motor problems. No NPSH issues.
- Space-saving size. Low-profile body fits in tight spaces while allowing minimal fill head.
- Lower installation costs. Single trade installation.
- Peace of mind. Intrinsically safe.
- Ductile iron durability. Rugged construction material means long service life.
- Efficiency. A closed loop means no motive or flash steam is lost. All valuable heat is captured and returned to the system.
- Safety. The trap/pump can be used in pits or sumps without fear of electrocution or circuit breaker defaults.



Double Duty® 4

### Maximum Operating Conditions

Maximum allowable pressure:  
EDD-4 5 bar @ 160°C

Maximum operating pressure:  
EDD-4 5 bar @ 160°C

### Materials

Body: Ductile iron  
Mechanism: All stainless steel  
Springs: 304 Stainless steel  
Float: All stainless steel

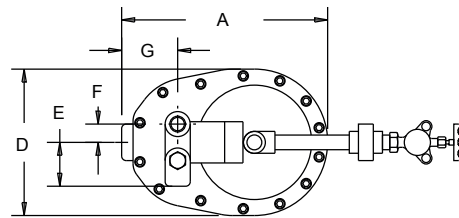
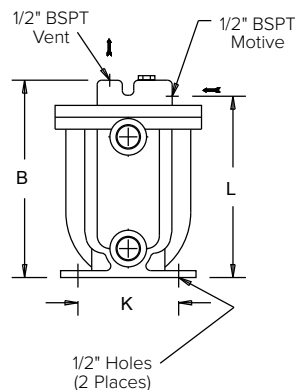
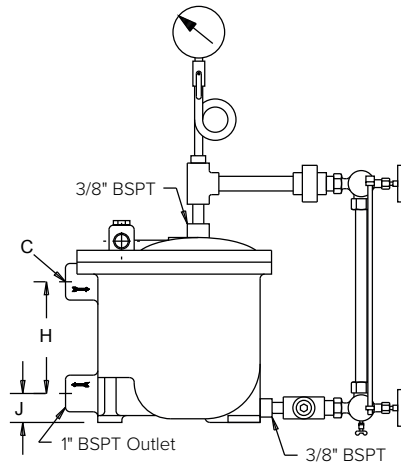

Table CRE-244-1. Double Duty® 4 Physical Data	
	mm
«A»	284
«B»	274
«C»	1"
«D»	203
«E»	61
«F»	25
«G»	76
«H»	155
«J»	41
«K»	140
«L»	251
Weight kg	17



All dimensions and weights are approximate. Use certified print for exact dimensions. Design and materials are subject to change without notice.

# Double Duty® 4

## Steam Trap/Pump Combination

**Table CRE-245-1. Double Duty® 4 Pump Capacities**

Motive	Back Pressure	Capacity
bar	bar	kg/hr
1 1,7 3,5 4,5	0,34	100 136 158 159
1,7 3,5 4,5	1	100 156 158
2,5 3,5 4,5	1,7	100 147 158
3,5 4 4,5	3	100 136 152
4,5	4	100

**Note:** Published capacities are based on the use of external check valves supplied by Armstrong. Fill head measured from drain point to top of pump case.

**Table CRE-245-2. Double Duty® 4 Trap Capacities**

Differential Pressure	Capacity
bar	kg-hr
0,34	610
0,7	900
1,4	1300
2,1	1550
3	1745
3,4	1850
4,1	1925
4,8	2 000

**Table CRE-245-3. Capacity Conversion Factors for Other Filling Heads**

mm	Filling Head		
	0	150	305
Double Duty EDD-4	0,65	1,0	1,10

**Note:** Fill head measured from drain to top of cap.